

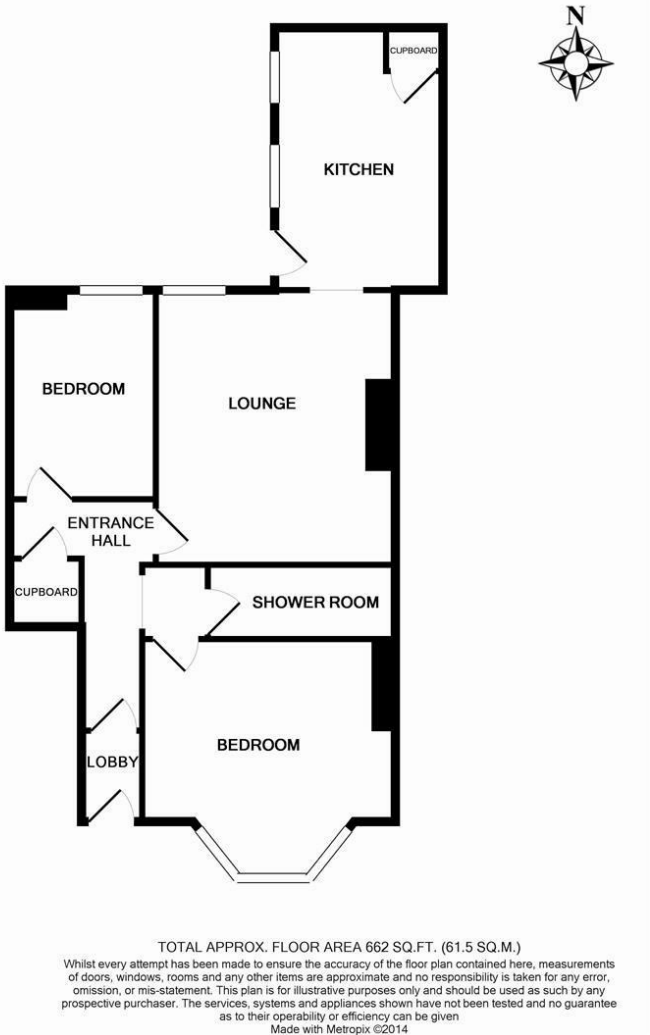

With no onward chain! This two bedroom ground floor flat is ideally located on Simonside Terrace, Heaton. Close to Chillingham Road, Simonside Terrace, is conveniently situated just a short stroll to the shops, cafes and restaurants as well as excellent transport links into the City and beyond.

The accommodation briefly comprises: entrance lobby through to entrance hall; two double bedrooms; shower room central to the property and accessed from the main hallway; lounge open to a modern 14ft dining kitchen occupying the full off-shoot. With gas 'combi' central heating, double glazing and a shared rear yard, an early internal inspection is essential!

Ground Floor Tyneside Flat | Two Bedrooms | 662 Sq ft (61.5m2) | 14ft Kitchen/Diner | Shower Room WC | Fully Double Glazed | Condensing Combination Boiler | Great Location | Council Tax Band: A | Leasehold - Tyneside Lease with Peppercorn Rent - 965 Years Remaining | EPC Rating: C



**Offers Over £150,000**

**IMPORTANT NOTE:** These particulars and the descriptions and measurements herein do not constitute representation and whilst every effort has been made to ensure accuracy, this cannot be guaranteed.

